



YOSHINE LIGHTING

2025

**SHENZHEN YOSHINE LIGHTING
CO.,LTD**

START

- E-mail: michelle@yoshinelighting.com
- Skype: [yoshinelighting](https://www.yoshinelighting.com) www.yoshinelighting.com
- Tel: 86-0755-33131087 whatsapp:86-18218811908
- Add:5Floor, 2nd building, HanYu industrial park, LongXi Road.
JiangHai district, JiangMen. China. 529000



CONTENTS

1 COMPANY

2 PRODUCT

3 FACILITY

4 PROJECT



Company brief introduction

About us / Who we are

Shenzhen Yoshine Lighting is among the industry's leading designers and suppliers of energy-efficient lighting systems for commercial, architectural, educational and residential applications. Founded in 2008. Over last 10 years. Yoshine products have become benchmarks for innovation, quality and new energy-efficiency standards. With great capacity of technological innovation. Research and development. Experience. The company has gradually modified its products range. Focus its business on façade. architectural and landscape lighting for indoor and outdoor areas. these products are developed for domestic use as well as export to many countries in North and south America. Europe . Middle east and Asia Pacific. Yoshine product range offers customers a wide choice of standard as well as bespoke luminaires for their specific lighting needs.





Product pictures

These fixtures is design for architectural field. such as hotel facade, commercial centre, landmarks, bridges, theme park etc .

Wall washer
fixture



Spot lighting
fixture



Architectural
linear light



Pixel light

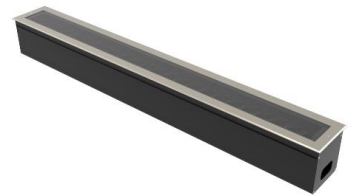
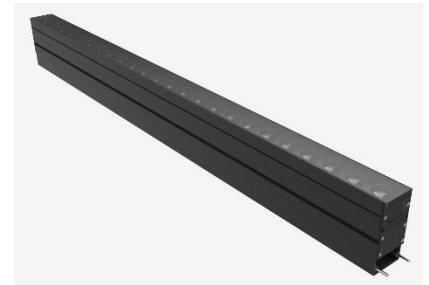



What we do

Production

One of the pioneer in world' s leading manufacturers in the architectural lighting market. Featuring a comprehensive catalog of proven quality. High realiability and fully waterproof lighting fixtures.



Design

Design with creative illumination to the building is what façade lighting. The movemen and building in the architectural skin of the building are accentuated through a layering of the façade lighting.

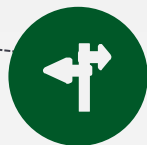

Installation

Our engineering and installation team is well equipped with state of the art machinery. Enabling our workforce to carry out our tasks with highest precision. Our years of experience in civil and engineering field help us achieve this.

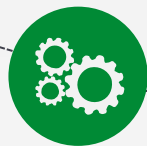

Supply

Our supply team ensures that the right products are made available in right quantity. At right place. In right time. Ready for immediate use and ideal for façade lighting application

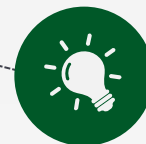

Maintenance

By renovating your lighting technology. You save energy and thus. Money. When your lamps are upgrated or retrofitted at the same time. It is a good idea to plan on a group relamp. For façade lighting maintenance no look further than us.



Creative illumination

We offer creative external illumination in and around your facility. In such a way to create enchanting ambiance. Designing in sync with on trend technology and keeping in mind the cause of lighting as well as locale.



Our Advantages

Innovation

With keep an eye on industrial news. Product s. And collect the comments from our customers to improve and develop our new items. Most of our projects are specifically customized. Usually develop 3-5 new items per quarter.

Design

With a complete design teams from structure design. Electronic and circuit design. Solution design. And make the project effect according customer ideas.

Flexibility

No matter big or small project. Which all can enjoy our quality service. And we prepare a lot raw material to handle the urgent orders.

Professionalism

There is an professional team of our company. From design. Product recommend. Commissioning process. Installation . these all can get our fully support.

Cooperation

No matter where you are. No matter big or small. No matter contractor. architect. distributor you are. We warmly welcome you!

Credibility

We keep strictly promise on quality. Quantity. Delivery time. After-sales service.

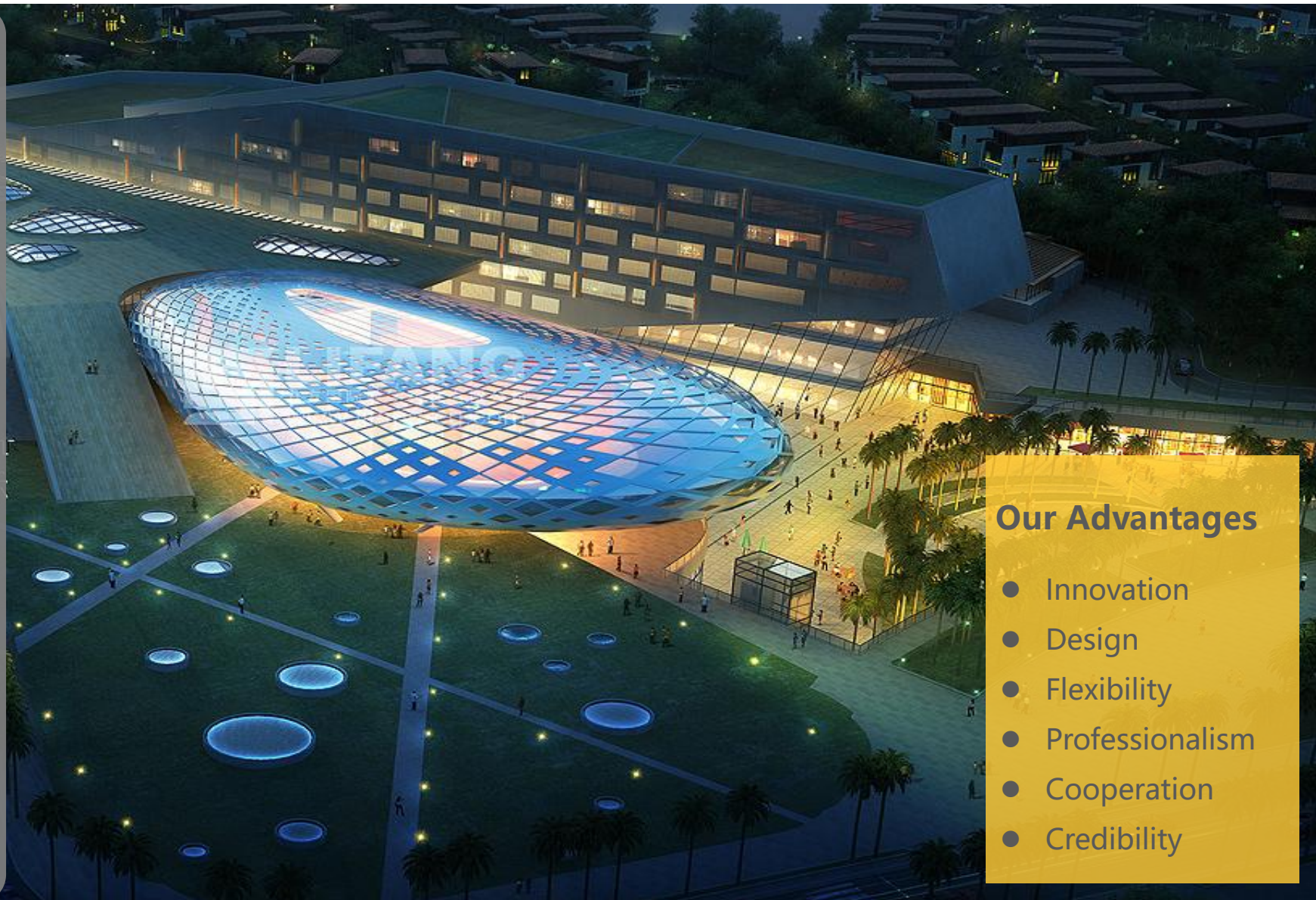

Our Advantages

- Innovation
- Design
- Flexibility
- Professionalism
- Cooperation
- Credibility



Our Advantages

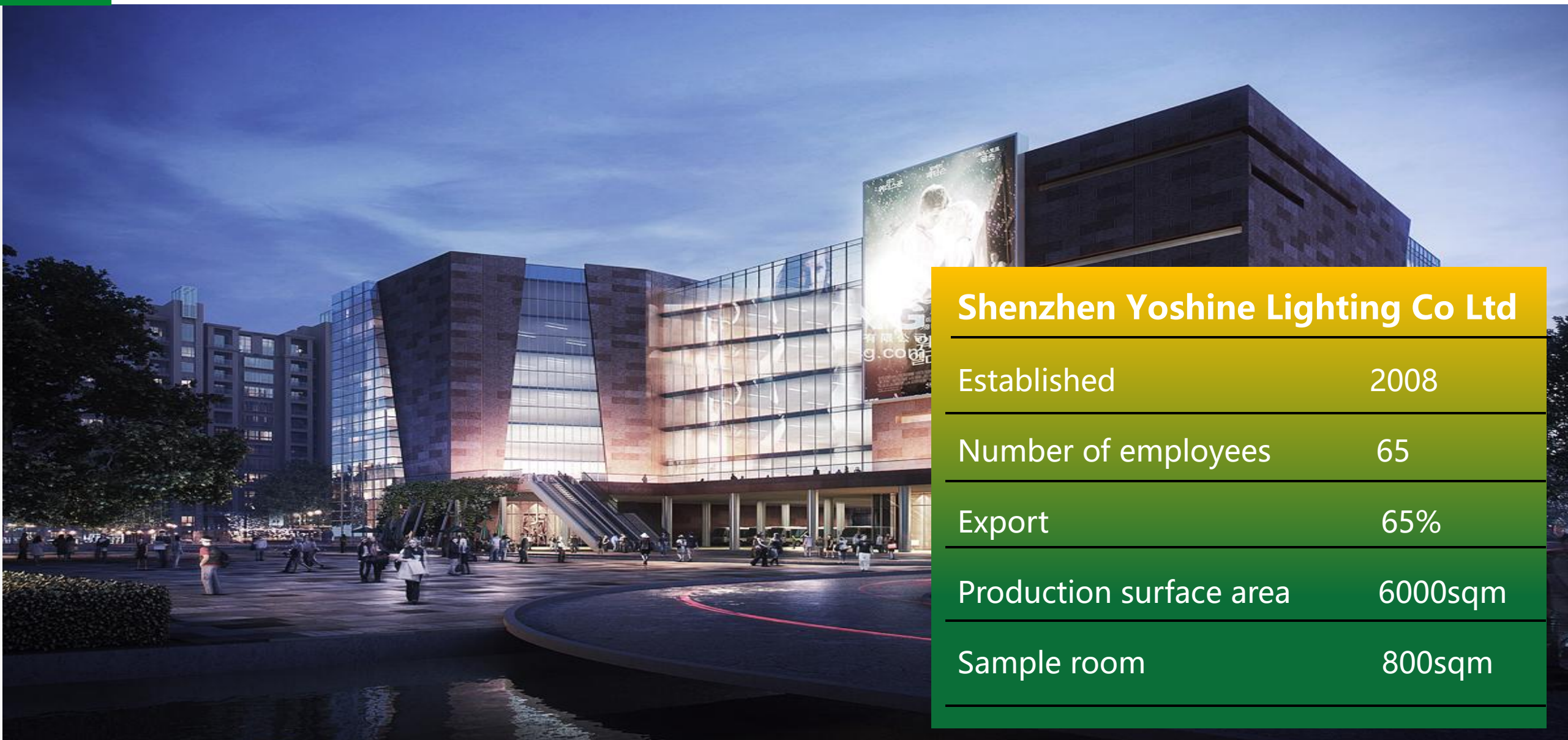

Shenzhen Yoshine Lighting Co Ltd

Established	2008
Number of employees	65
Export	65%
Production surface area	6000sqm
Sample room	800sqm



Manufacture

- **Technologies**

We invest in continual technological development. From software to hardware. To ensure stable quality during production.

- **Special request**

Our factory provided us with unrivalled flexibility. Which allow us to make very small and precise parts with ease and at speed.

- **LED production**

All of our LED chips are soldered using the selective wave method, all components and final products are thoroughly tested using precision equipment in line with stringent ISO 9001. LM80. Technical standard.

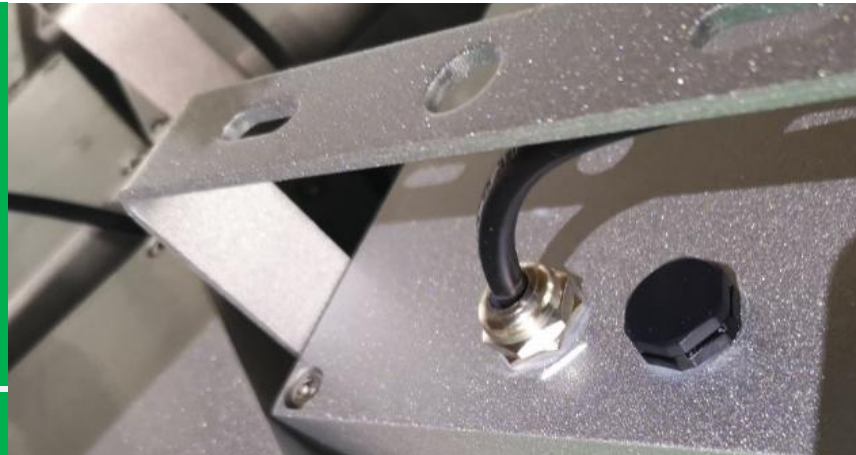



In House Research and development

● Industrial design

All the pre-production processes that lead to a fully functional prototype.

● Optical design

Selection and refinement of appropriate optical parts using vast practical experience and theoretical knowledge.

● Thermal design

Characterisation of every product to ensure the reliability of every product and R&D of innovative concepts

● Electronic design

Advanced system level design. Long term performance tests performed in-house.

● Mechanical design

More than 10 years of experience in the mechanical design and customization of luminaires and precision tools.

● Lab service

Optical. Thermal. Electronic. Mechanical and pre-certification tests and measurements.

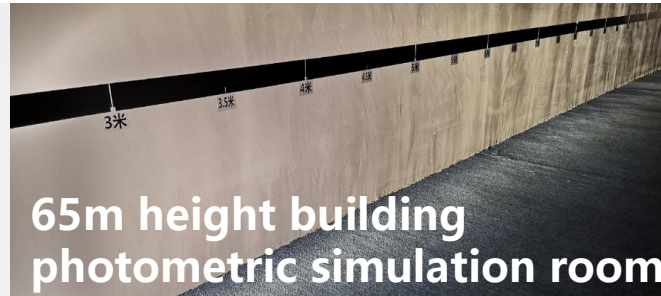

65m height building photometric simulation room



Full luminaire development

One of the best-equipped and staffed R&D department. Head engineer from Philips with more than 10 years experience. Delivering seamless industrial, optical, thermal, electronic, and mechanical design and custom product development.



Integrating Sphere



Goniophotometer



Digital Power Meter



IK Test



Drop Test



High Temp Test



Lighting quality standard

Lighting quality standard helps lighting professionals and customers understand how to choose the perfect luminaire.

LEDs



CREE

OSRAM

PHILIPS

Driver



HEP

TCI LED
professional led applications

MW
MEAN WELL

TRIDONIC

Lens



LedLink
Linking LEDs to The Real World

LEDiL

Test

LM-80

IES Illuminating
ENGINEERING SOCIETY

UL **CE**

RoHS



Production Facility

Production Facility list

No	1	2	3	4	5	6	7	8	9	10	12	13	14	15
Name	Saw machine	UV oven	Automatic fill machine Silicone	Automatic fill machine PU	Automatic fill machine Glass glue	Pneumatic lighting end cap press	Pneumatic lighting glass press	Pneumatic lighting glass press	Automatic lens fill machine	Dryer	Depanel machine	Pick and Place	Solder reflow	Automatic solder paste scraping machine
Manufacture	ZS QINGLONG	HUITAI	GDS	GDS	GDS	HET	QINGLONG	BP	HC	CW	NY	YBT	JB	ZSY
PN#	QN-A1037	HT-1300	TG-1200	TG-1200	TD-1200	HET-1200	QL-1100	BP-QYJ-03	HC-316	CW-180	NY-1300	ELM280X	JAGUAR A8	ZSW-120
Qty	1pcs	1pcs	1pcs	1pcs	1pcs	3pcs	3pcs	2pcs	5pcs	1pcs	2pcs	1pcs	1pcs	1pcs
Date of production	2005/5/8	2016/8/10	2014/6/13	2014/6/13	2013/6/15	2017/5/10	2015/3/26	2016/8/1	2020/7/15	2020/7/15	2016/3/1	2019/6/25	2019/6/30	2019/3/30
Rated capacity	500pcs/h	5000pcs/h	260pcs/h	260pcs/h	70pcs/h	60pcs/h	70pcs/h	90pcs/h	7200pcs/h	14400pcs/h	90pcs/h	16000/H	200pcs/pcs	80pcs/pcs
Production unit	Hardware parts processing	Fixed large optical lens	Fill silicone for direct view linear	Fill PU for direct view linear	Fill glass glue for wall washer	Structure waterproof end cap	Structure waterproof floodlight	Structure waterproof wall washer	Automatic optical lens fill for wall washer	Dry optical lens glue	Split PCB	PCBA components work		Solder paste scraping



Inspection Facility

Inspection Facility list

No	1	2	3	4	5	6	7	8	9	10	11	12	13	14	15	16	17	18	19
Name	IES	Spectrum	Vibration testing	Power meter	Temperature and Humidity	Power meter	Multi-channel temperature recorder	Multi-channel temperature recorder	Multi-channel temperature recorder	Voltage withstand	LCR digital electric bridge	LED aging test	Salt mist test	Spray test	Ground Resistance Tester	Digital display insulation resistance tester	Precision DC stabilizer	Outside diameter micrometer	Air tightness
Manufacturer	EVERFINE	Inventfine	HT	NP	HT	DCUU	Inventfine	Inventfine	Inventfine	CY	XB	JXS	HT	TH	MRK	MRK	MS	SL	HF
PN#	GO-2000	CMS-3000S	HT-600	PM9800	HT-H-408L	PM9800	TCP-8X	TCP-8Y	TCP-16X	CS2670A	LY2810B	JXS-103G	HT-SLHT100	TH-Z120	RK2678XM	RK2682	MS6003D	0-25MM 0.001MM	HF-HYQ
QTY	1	1	1	1	1	1	1	1	1	1	1	1	1	1	1	1	1	1	2
Accuracy	1	1	1	1	1	1	1	1	1	1	1	1	1	1	1	1	1	1	1
Inspection	Luminaire performance	Luminaire performance	Safe shipping	Electrical parameter	High temp	Electrical parameter	Temperature rise test	Temperature rise test	Temperature rise test	Safety Compliance Testing	Electrical parameter	Luminaire stability test	Anti-corossion	IP65	Safety compliance testing	Safety compliance testing	Luminaire test	Luminaire test	Air pressure tightness



Machine pictures

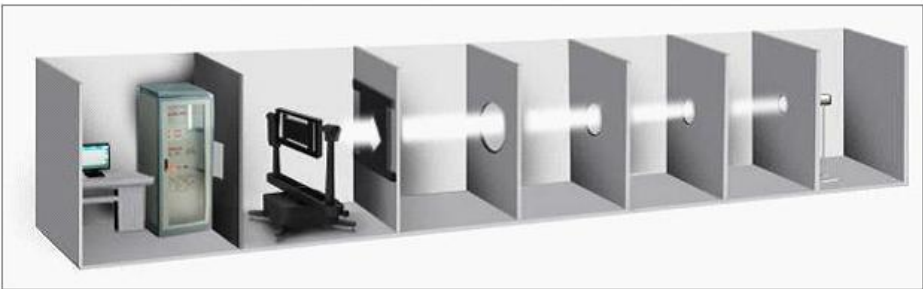

光度分布计



积分球



恒温试验箱



IP65喷淋流水线



盐雾测试仪



成像亮度器

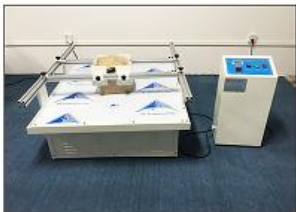

震动测试仪



UV固化机



半自动灌胶机



半自动打胶机



智能灯具老化车



电源老化测试仪



耐压测试仪



绝缘电阻测试仪



数字电桥



接地电阻测试仪

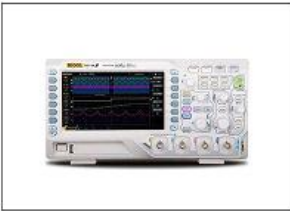

示波器



示波器1



LED结温测试仪



温度测试仪



小功率测试老化台



Production line





Central park towers DIFC Dubai





Using place and Successful case





THANKS

**SHENZHEN YOSHINE LIGHTING
CO.,LTD**

- E-mail: michelle@yoshinelighting.com
- Skype: [yoshinelighting](https://www.yoshinelighting.com) www.yoshinelighting.com
- Tel: 86-0755-33131087 whatsapp:86-18218811908